

**CONCRETE | WOOD | FERMACELL 2E32, SUSPENDED CEILING WIRES AND CHANNELS | NAILED DOWN**

Acoustic performance

AllC: 65 to 73

ASTC: 65 to 70

**ASSEMBLY DETAILS**

**STRUCTURE**

Concrete

**ASSEMBLY COMPONENTS**

Fermacell 2E32, Suspended ceiling wires and channels

**FLOOR TYPE**

Wood

**INSTALLATION TYPE**

Nailed down

**CEILING TYPE**

Suspended

**NUMBER OF GYPSUM**

1

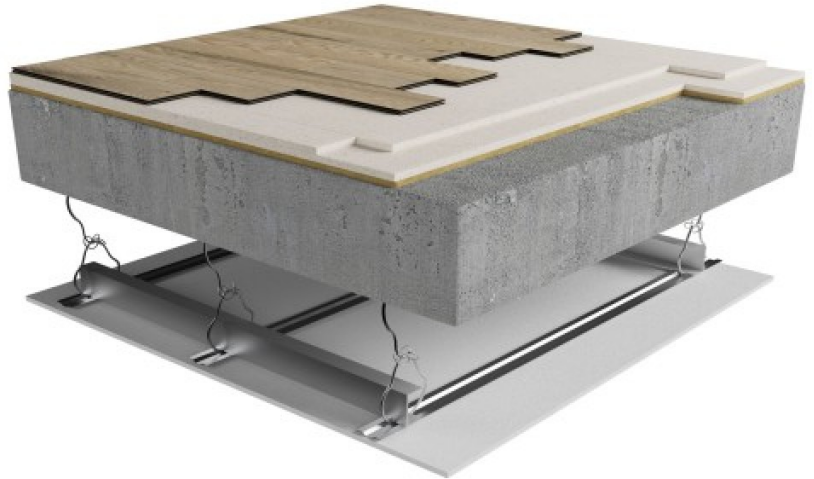

**FERMACELL 2E32**

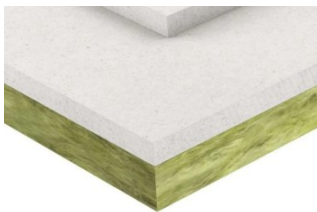

[Plus de détails](#)