

CONCRETE | CERAMIC | FLEXIBLE MORTAR, MORTAR, SONO/MAX25 | MORTAR

Acoustic performance

AllC: 59 to 63

ASTC: 59 to 63

ASSEMBLY DETAILS

STRUCTURE

Concrete

ASSEMBLY COMPONENTS

Flexible mortar, Mortar, SONO/MAX25

FLOOR TYPE

Ceramic

INSTALLATION TYPE

Mortar

GLUE

Mortar (Min. ANSI 118.4)

CEILING TYPE

None

NUMBER OF GYPSUM

0

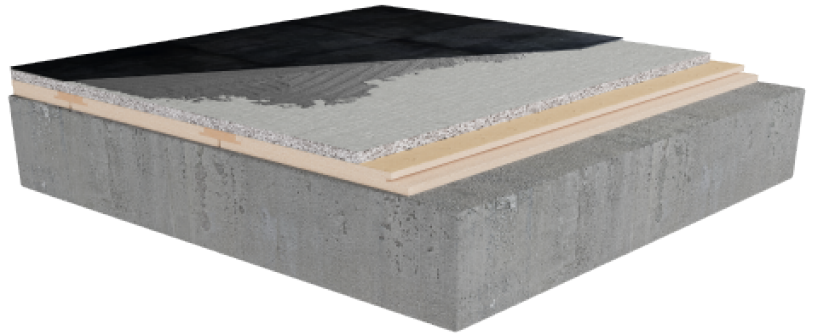

SONO/MAX25



Plus de détails