

**STEEL | WOOD | FERMACELL 2E32, CONCRETE SLAB (APPROXIMATELY 3-4"),
SUSPENDED CEILING WIRES AND CHANNELS | NAILED DOWN**

Acoustic performance

AIIC: 53 to 58

ASTC: 58 to 62

ASSEMBLY DETAILS

STRUCTURE

Steel

ASSEMBLY COMPONENTS

Fermacell 2E32, Concrete slab
(approximately 3-4"), Suspended ceiling
wires and channels

FLOOR TYPE

Wood

INSTALLATION TYPE

Nailed down

CEILING TYPE

Suspended

NUMBER OF GYPSUM

1

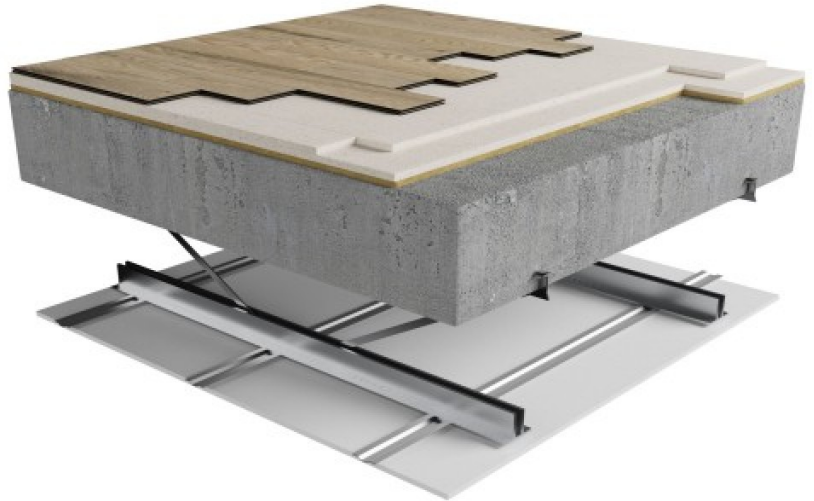

FERMACELL 2E32

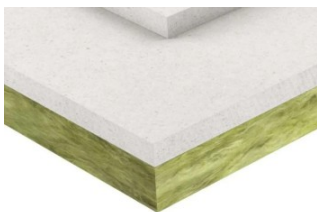

Plus de détails